

WDD - Grommet

1 Application

Grommets Type WDD allow measuring lines or cables to be passed through walls of up to 5 mm thickness, especially of INTERTEC enclosures.

2 Features



- Fast and easy to install
- Provide a tight seal
- Angles of up to 75° are permissible when installing the piping without affecting the seal
- Measuring lines can easily be disassembled as the drilled hole for the WDD in the wall allows the nut of the tube fitting to be passed through without any difficulty
- Cost effective alternative to bulkhead fittings

3 Description

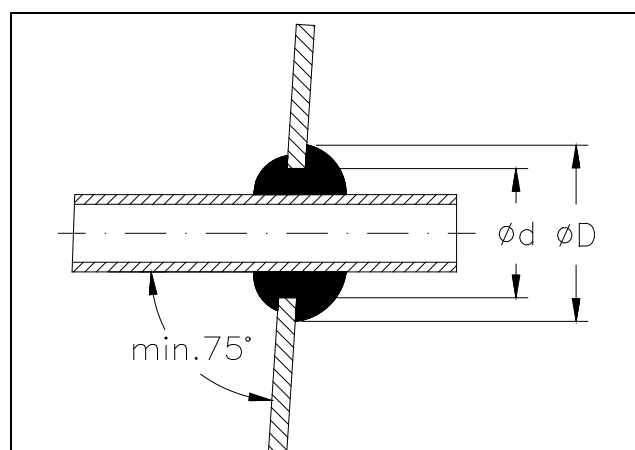
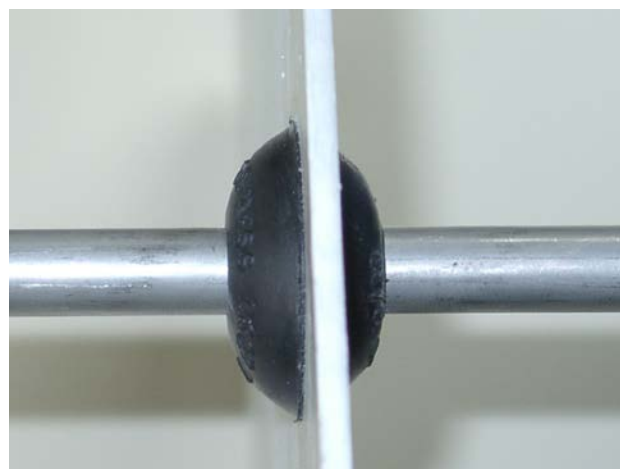
WDD grommets are made of EPDM or silicone. This material is permanently elastic and resistant to a large number of chemicals and ozone.



4 Technical Data

Type		Diameter of pipe (mm)	Diameter of drill hole Ø d (mm)	WDD Ø D (mm)	with Membrane	Material	Temperature Resistance	Protection Degree
	WDD 6/16	6	17	28	-	EPDM	-50° ... +120°C	IP65
	WDD 8/20	8	21	31	-			
	WDD 12/25	12	26	36	-			
	WDD 12/25 L	12	26	36	X			
	WDD 12/28	12	29	40	-			
	WDD 16/32	16	33	43	-			
	WDD 21/30	21	31	41	-			
	WDD 6/16 S	6	17	28	-	Silicone	-60° ... +200°C	
	WDD 8/20 S	8	21	31	-			
WDD 12/25 S	12	26	36	-				
	WDD-U 16/20	16	20	27,5	X	EPDM	-50° ... +120°C	
	WDD-U 16/25	16	25	34	X			

WDD - Grommet

5 Installation of WDD

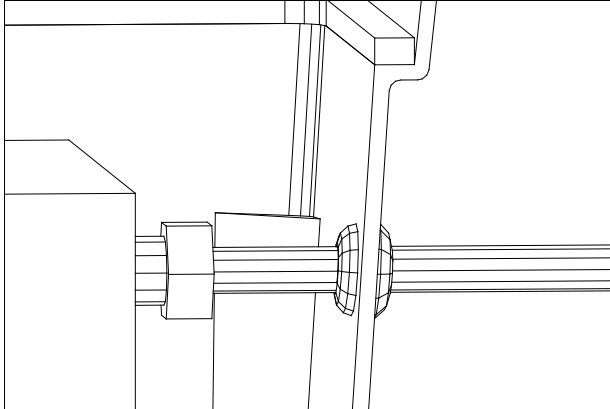

A good seal can only be guaranteed if the entire sealing surface is in close contact with the wall.

5.1 Installation of Measuring Lines

Drill hole of the recommended diameter (see-table).
Disassembled state Preinstalled state

1. Push WDD into the wall.
2. Apply a lubricant to the hole of the WDD and push the measuring line through starting from the larger section of the WDD.

5.2 Alternative Method of Installing Measuring Lines

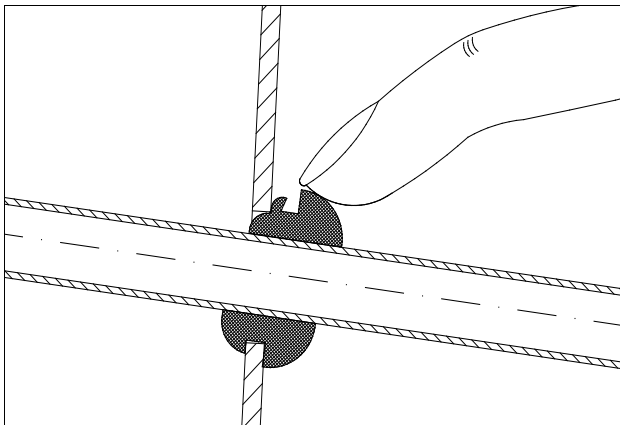

- 1 Drill hole of the recommended diameter (see table "sizes and measurements")
- 2 Push WDD onto the measuring line
- 3 Push WDD and measuring line at an angle to the drilled hole into the wall until as much as possible from the smaller half of the grommet appears on the other side of the wall
- 4 Pass through the sealing lip that hasn't come through yet by using the assembly tool.

A suitable tool can be ordered under the designation "Assembly tool for WDD (Part No.KVAA)".

6 Installation of Capillary Lines

Capillary lines of transmitters with remote diaphragm seal can be easily pushed through the pre-cut slots in the enclosures and finally lock in place in a WDD that has been slit.

To ensure that the enclosure remains stable, the slots are reinforced with a counter plate after entry of the capillary on site.

Please advise the diameter of the capillary line when you place an order.

Example in MULTIBOX



Preinstalled enclosure with one or two capillary bushings

Example in DIABOX

